

# **ULTRA-GRID**

TM

Insulation Support System

- Easy to Install
- Higher R-Values
- New Build or Retrofit

## **Single Banding**

## **Double Banding**

***Simple and Effective Solutions***

# ULTRA-GRID

## BANDING SYSTEM

**Single Banding System** - consists of a 3/4" or 1/2" painted galvanized steel or 5/8" white polyester bands spaced 24" apart OC.

The Single Banding is primarily used for single layer insulation and retrofit systems. The ULTRA-GRID Single Banding System is a simple and cost effective solution to help decrease energy costs and improve interior appearance.

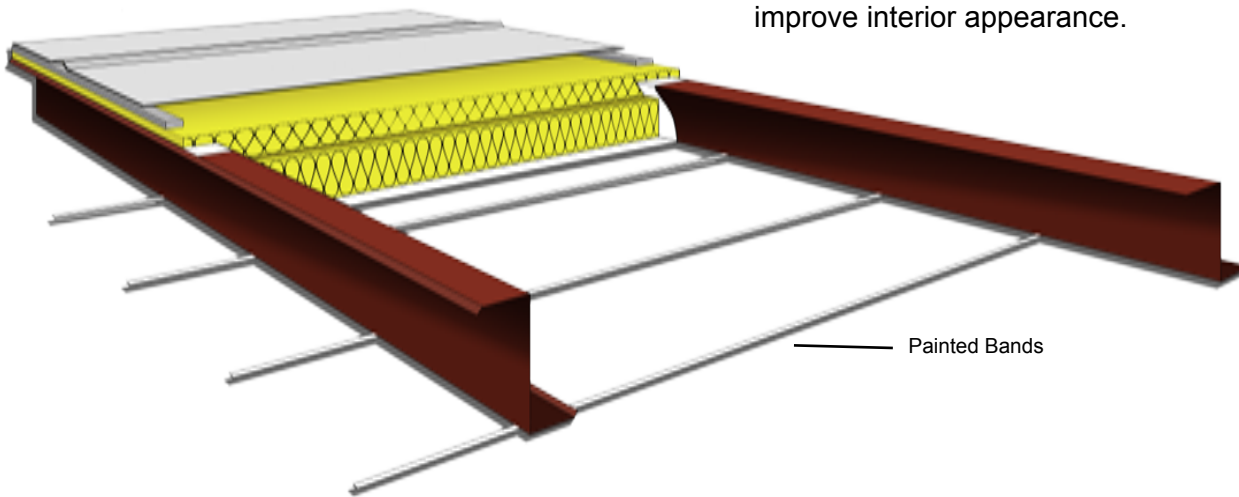

The ULTRA-GRID Double Banding System is typically used for double layer insulation systems. 3/4" painted metal bands run perpendicular to the purlins while 3/8" painted metal bands run parallel to provide the ultimate support.

**Double Banding System** - consists of a 3/4" painted galvanized steel bands spaced 48" apart OC and 3/8" painted galvanized steel bands evenly spaced between the purlins.

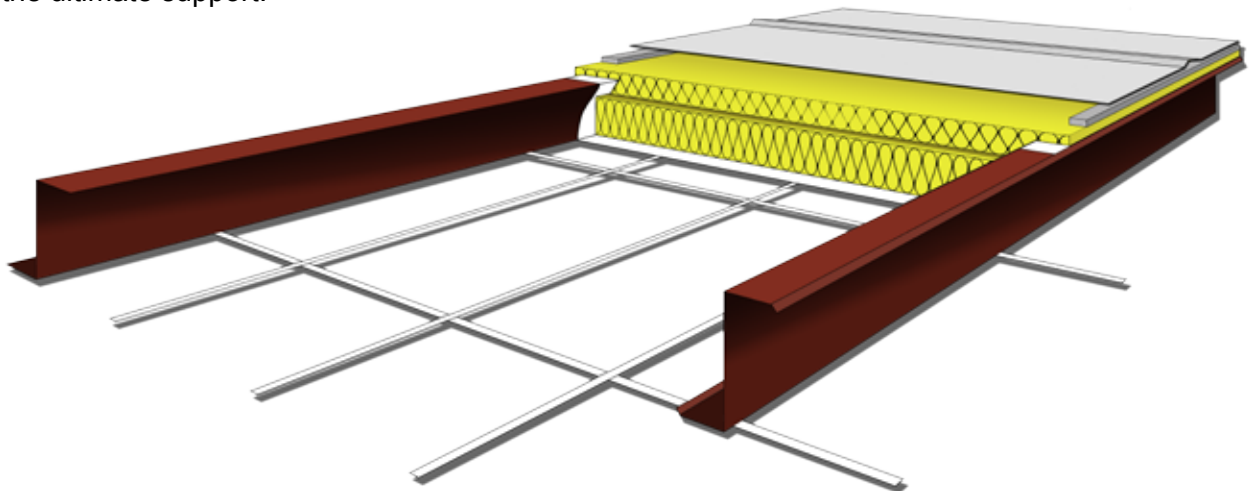

# BENEFITS

- **Achieve Higher R-Values**
- **Quick and Easy to Install**
- **Clean and Professional**
- **Ultimate Insulation Support**
- **New Build or Retrofit**
- **Long Lasting**

## NEW BUILD

The 1/2", 3/8" and 3/4" bands are made from galvanized steel to increase reliability and durability. Available in either white or black, the bands are pre-painted to provide a clean and professional appearance. The 5/8" bands are made from durable white polyester. Whether attaching to a "C" or "Z" purlin, the ULTRA-GRID Banding System provides the optimal insulation support for both single layer and double layer insulation systems.

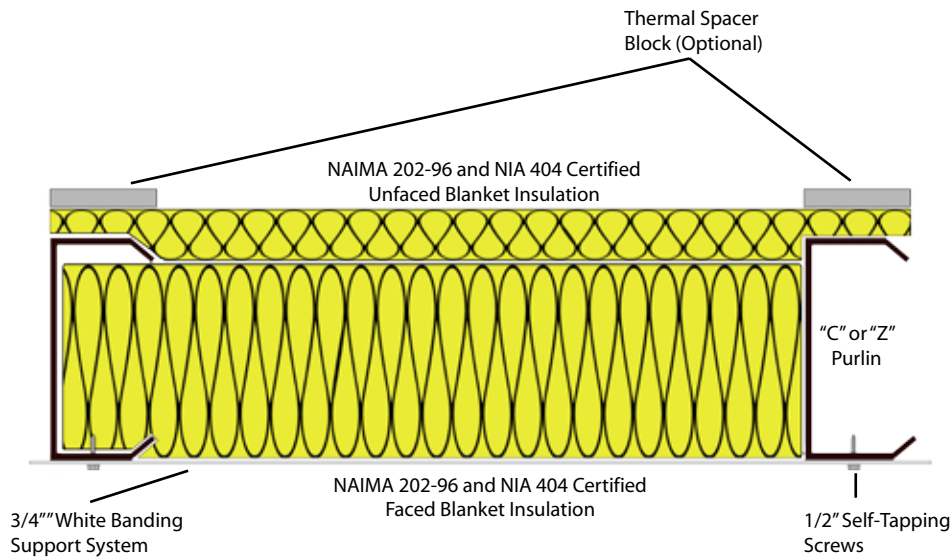

## RETROFIT

The ULTRA-GRID Banding System is the perfect insulation support system for retrofit applications. Because the bands are attached to the bottom side of the purlins with simple self-tapping screws, retrofitting a metal building has never been easier. The ULTRA-GRID Banding System is designed to obtain higher R-Values with less labor and overall costs as well as providing a clean and professional finished product.

See back for installation instructions.



Fig. 1A



Fig. 1B

# ULTRA-GRID™

## Installation Instructions

### SINGLE BANDING

Starting at an endwall, measure 2' OC and attach the banding to the bottom of the eave strut and each subsequent purlin (spanning the width of the building) using 1/2" self-tapping screws (as shown in Fig. 1B). Banding attaches parallel to the rigid frame rafter and perpendicular to the purlins. Optimal spacing between banding is 2' OC.

### DOUBLE BANDING

Starting at an endwall, measure 4' OC and attach the 3/4" banding to the bottom of the eave strut and each subsequent purlin (spanning the width of the building) using 1/2" self-tapping screws (as shown in Fig. 1B). 3/4" banding attaches parallel to the rigid frame rafter and perpendicular to the purlins. Optimal spacing between 3/4" banding is 4' OC. Attach 3/8" banding evenly spaced between the purlins using banding clips. 3/8" banding installs on top of the 3/4" banding. Refer to banding guide for the predetermined number of bands per purlin spacing. A banding tensioner is recommended to provide a tighter and cleaner finish.

### INSULATION

Unroll and place faced fiberglass insulation over the grids parallel to the purlins. Selle Supply's faced fiberglass insulation is delivered custom cut to fit each bay (plus 12 inches to allow for handling and stretching). It is very important to ensure the tabs on the faced fiberglass insulation are overlapping to maintain a consistent vapor retarder. Use tape every few feet or so to keep the tabs from separating during installation.

Unroll and position the unfaced fiberglass perpendicular to the purlins and over the already installed faced fiberglass insulation. Thermal Spacers are highly recommended to help obtain higher R-Values.

It is strongly recommended to use only 3rd party certified metal building insulation. NAIMA-202 96 and NAHB Certified NIA 404 post laminate fiberglass insulation provides optimal recovery value ensuring the entire cavity is filled.

**For retrofit applications**, attach stick pins 1' OC on top of the rigid frame rafter between purlins in every bay. Insulation is pulled tight through spacing in bay lengths and held in place with stick pins. To create a vapor barrier tabs must be joined at the base of the purlins and taped to prevent air leakage. Tabs can also be tucked up between the purlins and the insulation if a vapor barrier is not necessary.

Purlin Spacing	# of Bands
2'	1
3'	2
4'	2
5'	3

3/8" Banding Guide

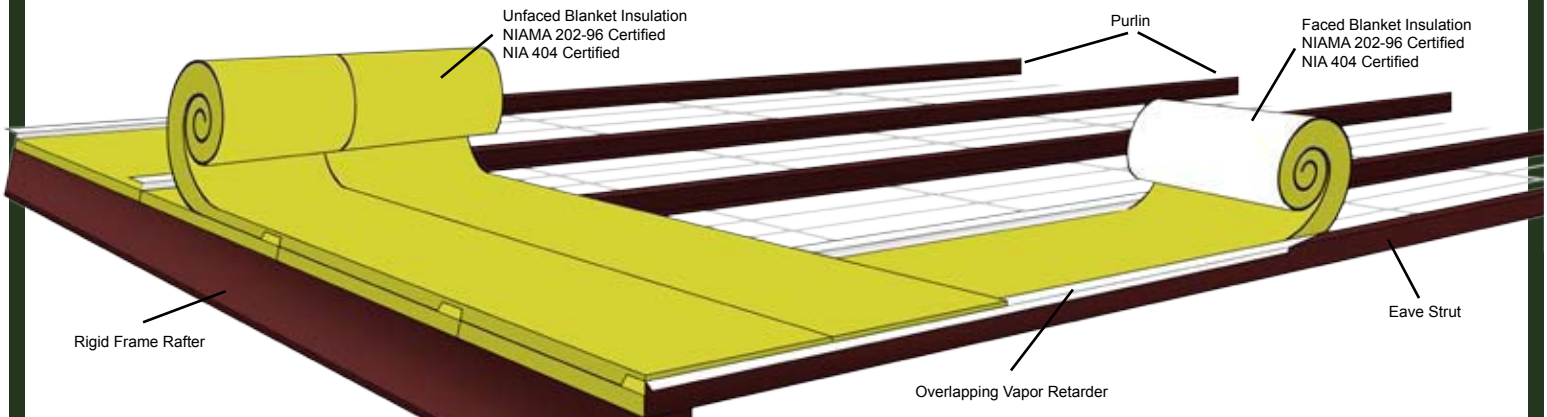

**SELLE SUPPLY COMPANY**

4602 Locust Ave.  
Lubbock, TX 79404  
(806) 747-3691 Ph  
(806) 744-3855 Fx  
1-800-937-3553

6711 Edith Blvd. Suite A  
Albuquerque, NM 87113  
(505) 843-7255 Ph  
(505) 843-6737 Fx  
1-800-234-4253

7344 Stiles Drive  
El Paso, TX 79915  
(915) 772-8525 Ph  
(915) 778-0176 Fx  
1-800-926-3499